

# 90 RESTART

# GEWISS

## RESTART RD/RD PRO/RM/RM PRO

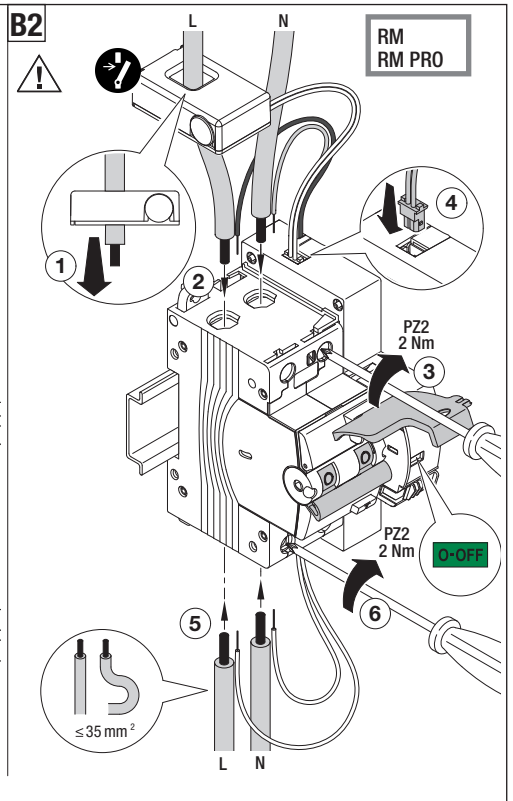

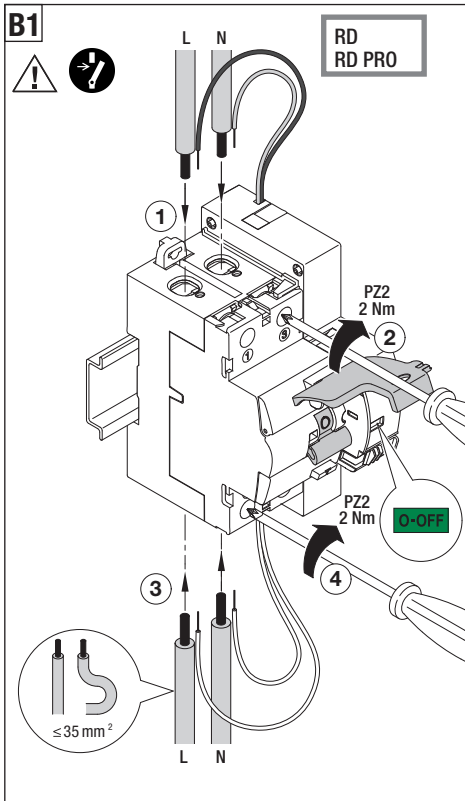
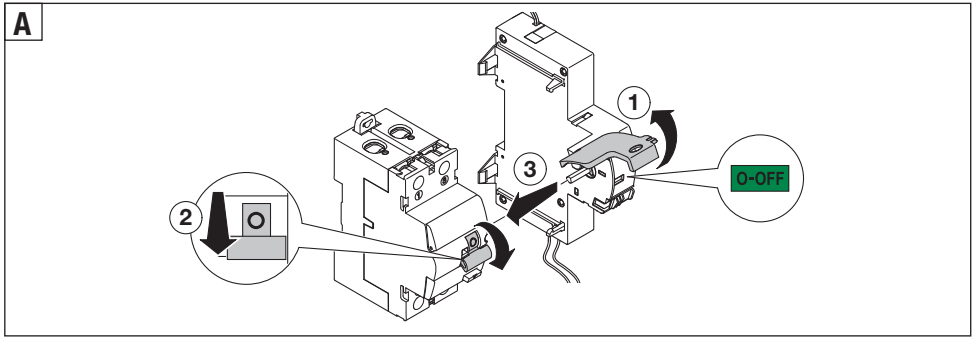

**C**

**RD, RD PRO**

TT, TN-S

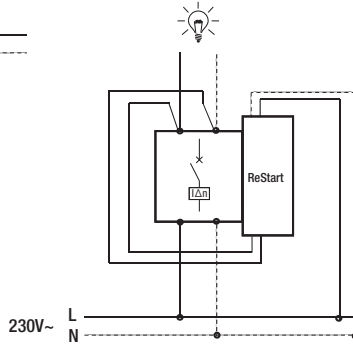
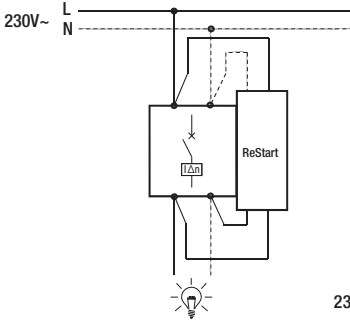

			Approval
	IDP NA 25-40-63A	6000A gG 63A	
	IDP 25-40A	10000A gG 63A	IMQ
	IDP 63A	10000A gG 80A	IMQ
	IDP 80-100A	6000A gG 100A	

**RM, RM PRO**

TT, TN-S

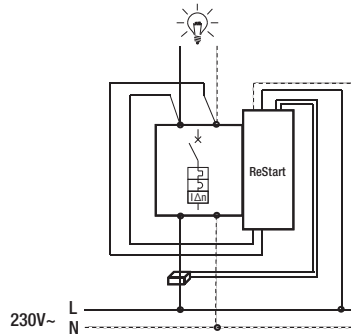
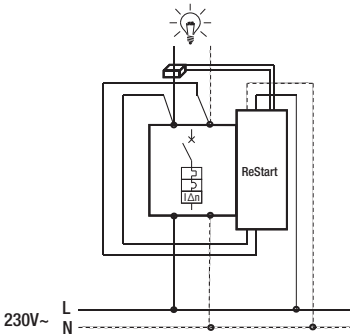
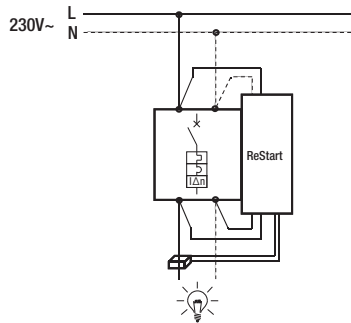
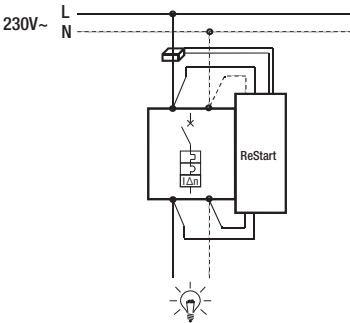

# OFF → ON

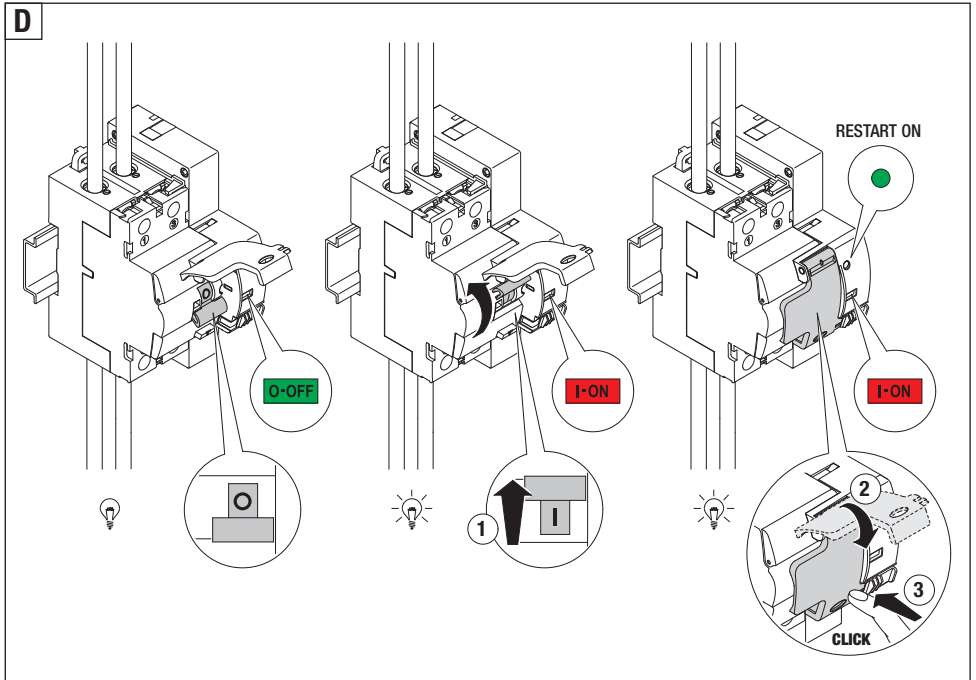

# ON → OFF

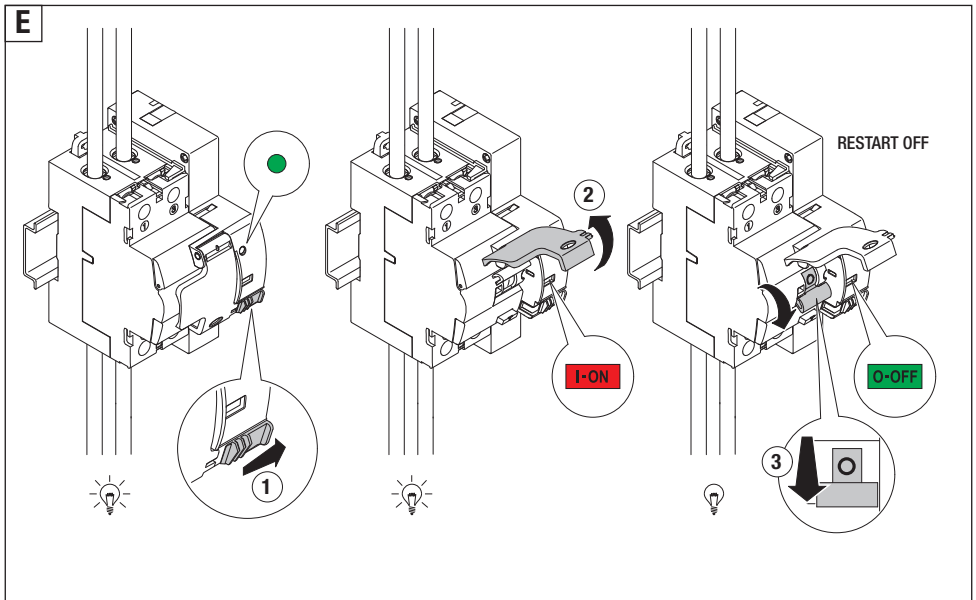

# TEST



F



1,2,3 ... 12

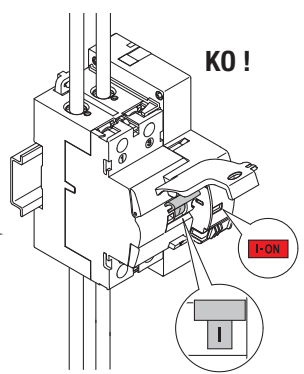
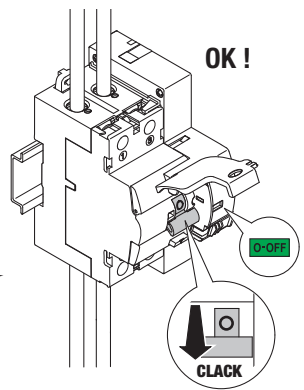
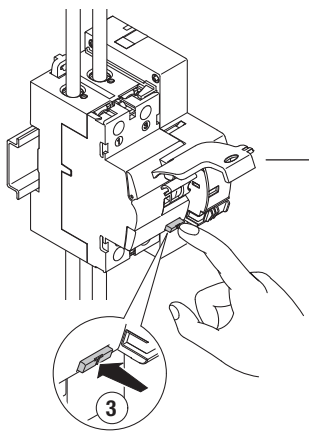
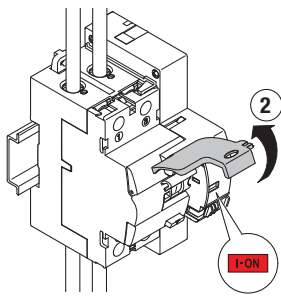
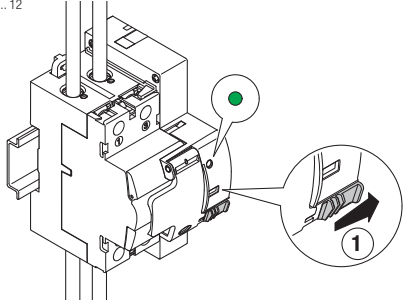

# TEST RESTART

G

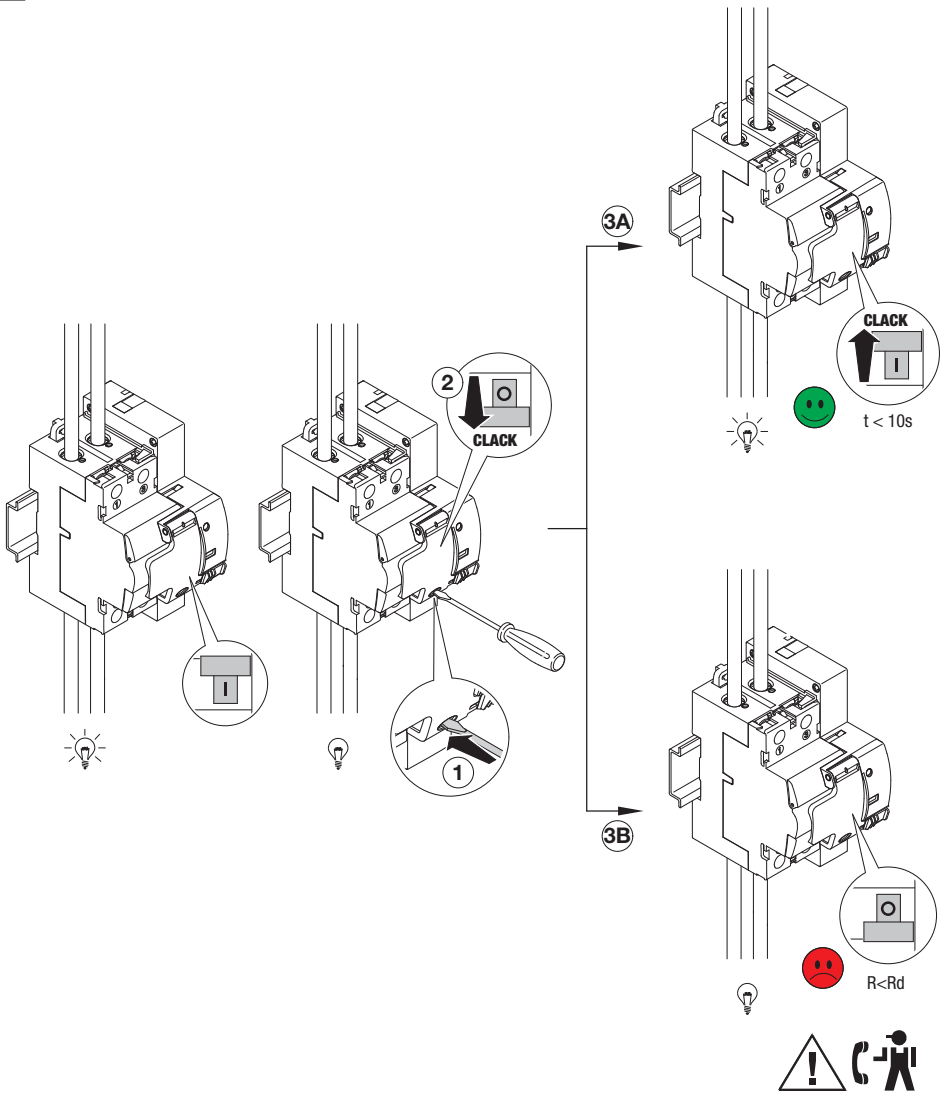

R=?

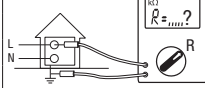

	RESTART RD / RD PRO	RESTART RM / RM PRO
30mA	100/300/500mA	
Rd	16kΩ	5kΩ
Rdo	8kΩ	2,5kΩ

# RESTART RD

H

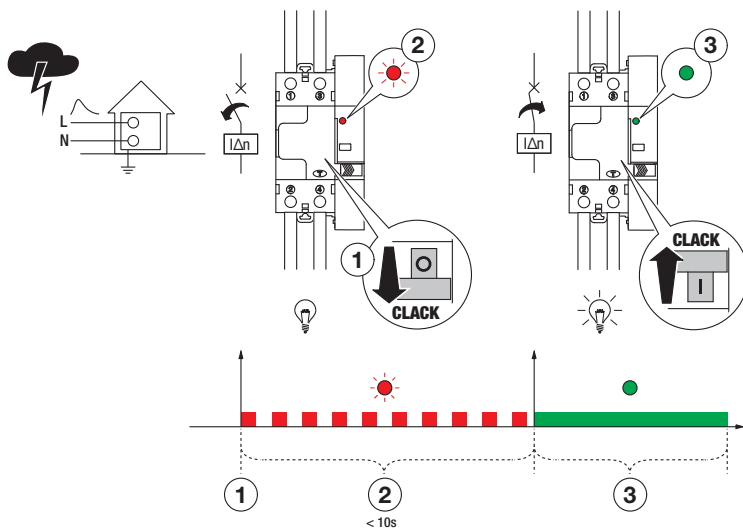

I

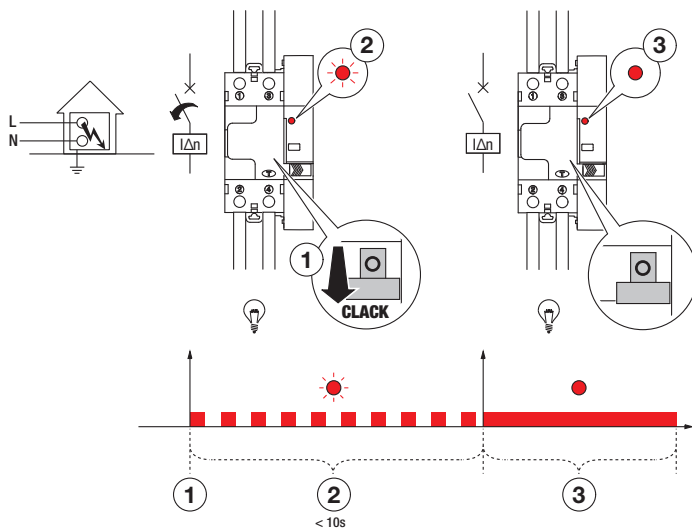

# RESTART RD PRO

L

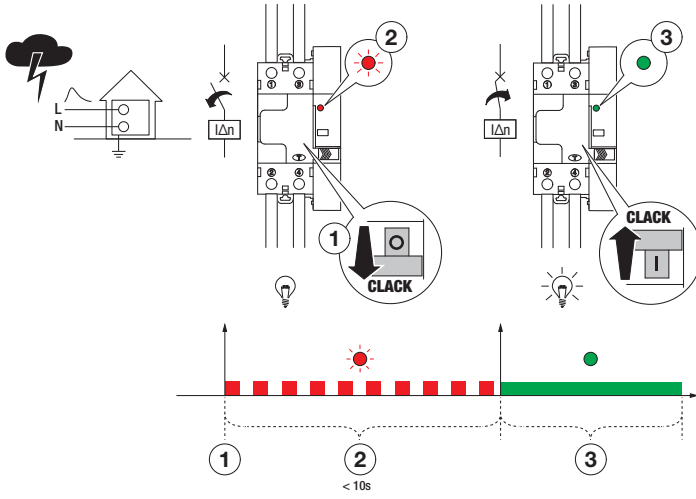

M

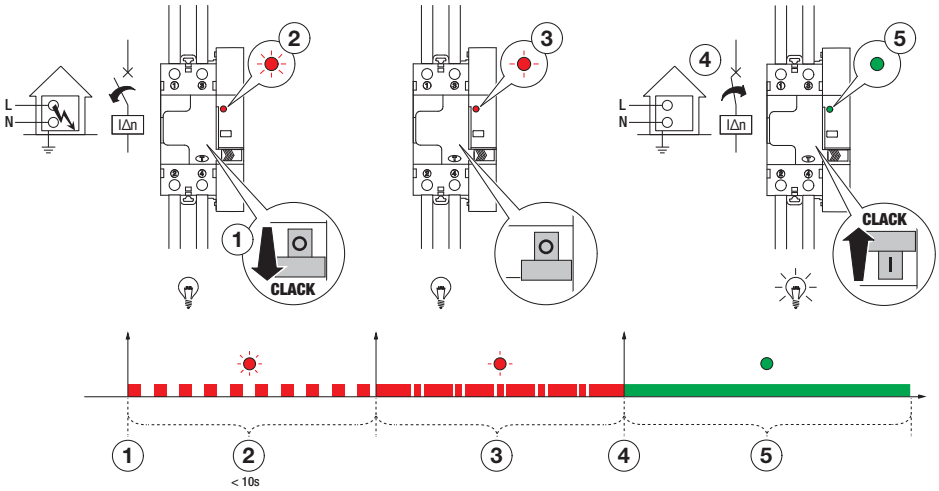

# RESTART RM

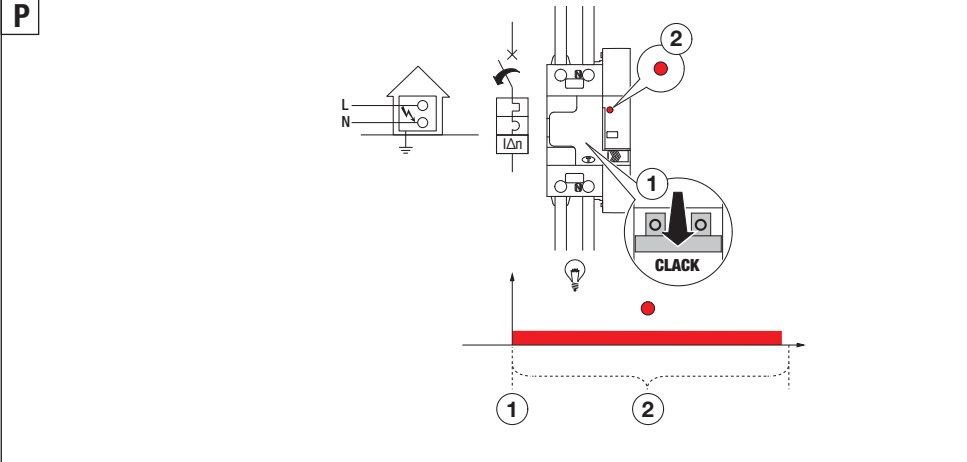
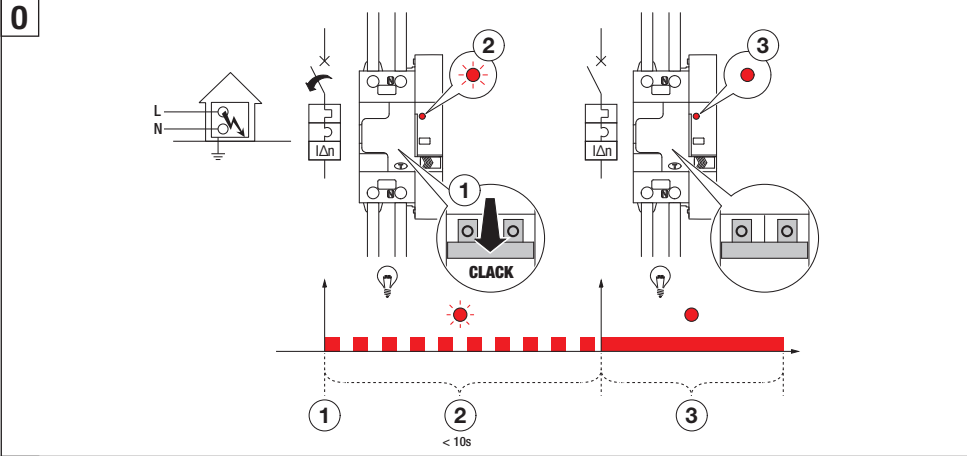
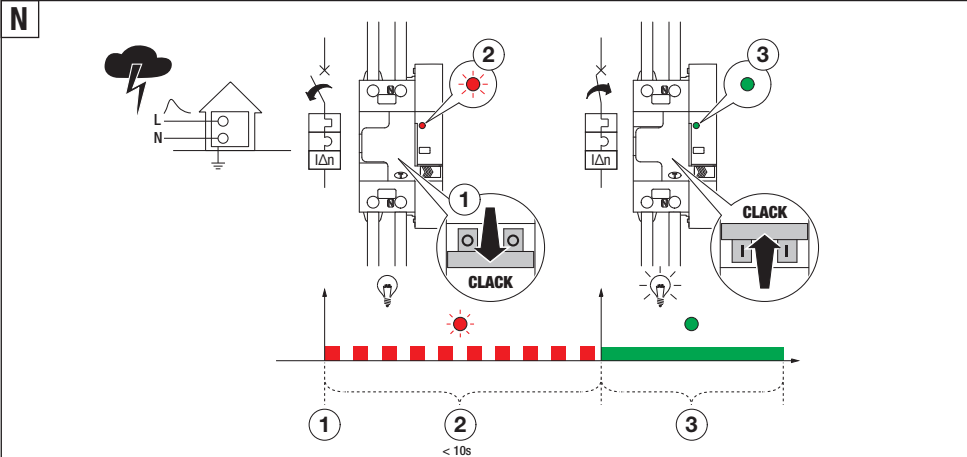



# RESTART RM PRO

Q

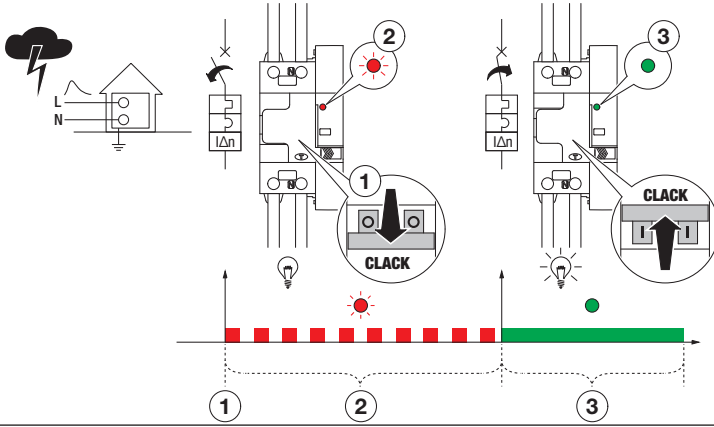

R

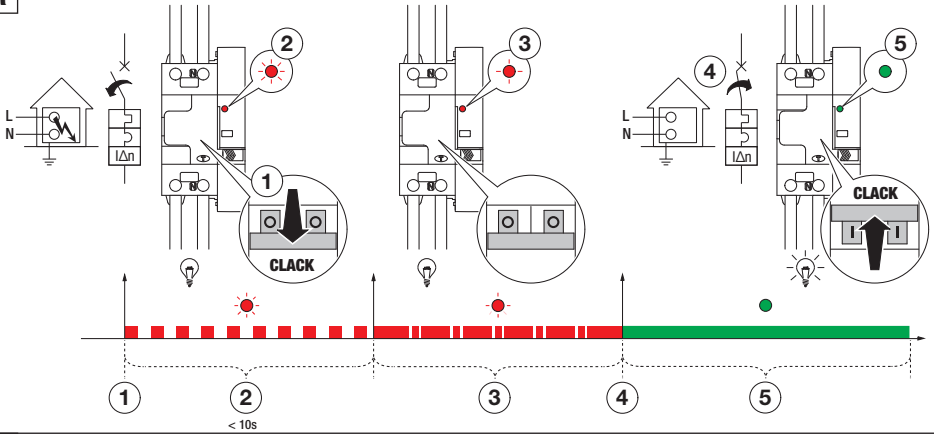



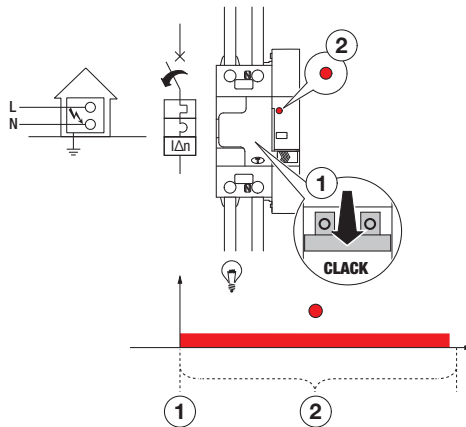

S







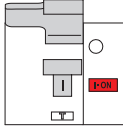

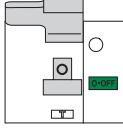

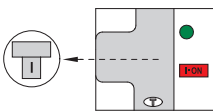

# RESTART RD/RM

			
---	---	--	--

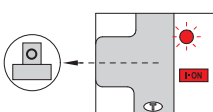
## RESTART OFF

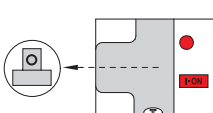
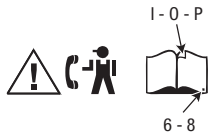
	I - ON 		
	O - OFF 		

## RESTART ON

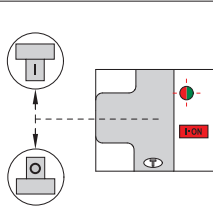
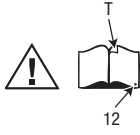

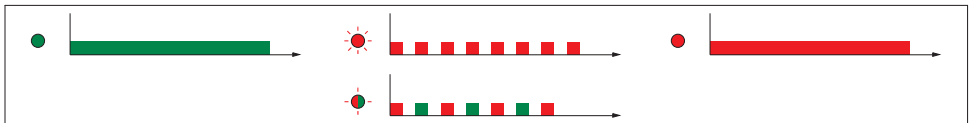

	I - ON 		
	O - OFF 		Restart (t < 10s)
	O - OFF 		
	I - ON  O - OFF 		







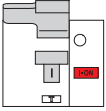

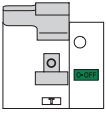



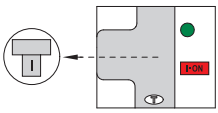

# RESTART RD/RM PRO

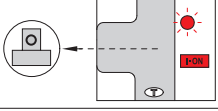
			
---	---	--	--

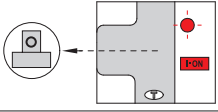
## RESTART OFF

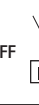
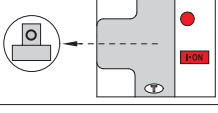
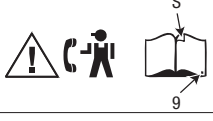
	I - ON 		
	0 - OFF 		

## RESTART ON

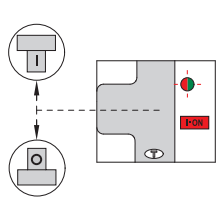
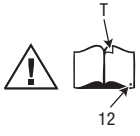
	I - ON 		
	0 - OFF 		Restart (t < 10s)
	0 - OFF 		
	0 - OFF 		
	I - ON  0 - OFF 		

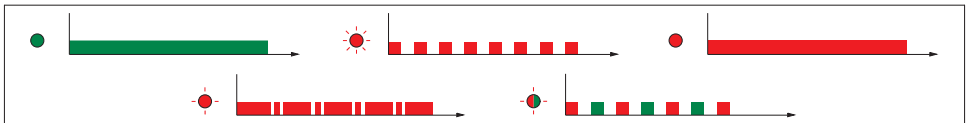

# RESET

cod. 7.43.2.834.5

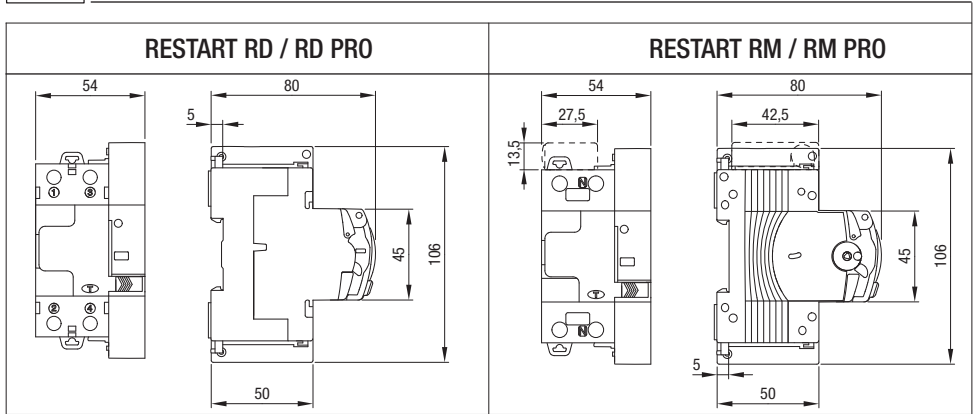
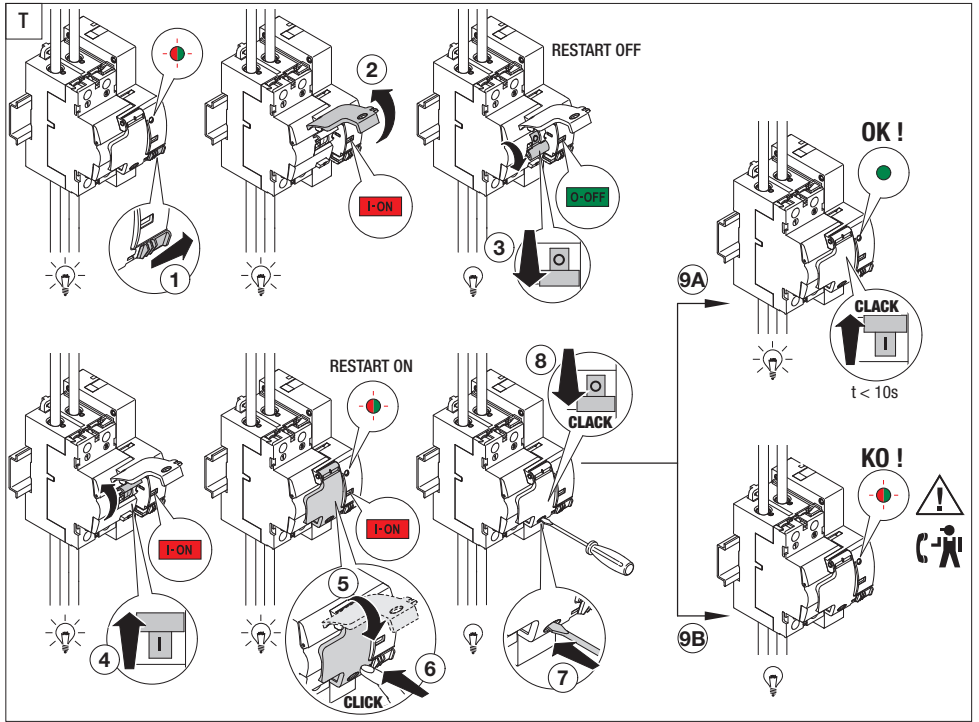

Punto di contatto indicato in adempimento ai fini delle direttive e regolamenti UE applicabili:  
 Contact details according to the relevant European Directives and Regulations:

GEWISS S.p.A. Via A.Volta, 1 IT-24069 Cenate Sotto (BG) Italy Tel: +39 035 946 111 E-mail: [qualitymarks@gewiss.com](mailto:qualitymarks@gewiss.com)



+39 035 946 111  
 8.30 - 12.30 / 14.00 - 18.00  
 lunedì + venerdì - monday + friday



+39 035 946 260



[sat@gewiss.com](mailto:sat@gewiss.com)  
[www.gewiss.com](http://www.gewiss.com)

ULTIMA REVISIONE 10/2017