













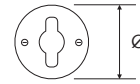

SERIE
Volux



Componibile per scatole tipo 503:
supporto, placca, frutto
in fine porcellana bianca

Riferimenti: Direttiva Bassa Tensione



ASPETTO	CODICE	DESCRIZIONE	MISURE	PZ
	8870	Interruttore rotativo 10A - 250V- completo di viti	∅ 78 mm H 26 mm	12 
	8871	Deviatore rotativo 10A - 250V- completo di viti	∅ 78 mm H 26 mm	12 
	8872	Pulsante rotativo 10A - 250V- completo di viti	∅ 78 mm H 26 mm	12 
	8873	Pulsante a tasto ottonato 6A - 250V- completo di viti	∅ 78 mm H 20 mm	12 
	8875	Presca polivalente 2P+T 10/16A - 250V- completa di viti	∅ 78 mm H 13 mm	12 



Componibile per scatole tipo 503:
supporto, placca, frutto
in fine porcellana bianca

Riferimenti: Direttiva Bassa Tensione

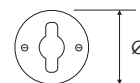

ASPETTO	CODICE	DESCRIZIONE	MISURE	PZ
	8876	Presa universale 10/16A + schuko 250V- completa di viti	Ø 78 mm H 24 mm	12 
	8879	Presa TV Ø 9,5 mm completa di viti	Ø 78 mm H 13 mm	12 
	8881	Presa telefonica con plug 6/4 completa di viti	Ø 78 mm H 13 mm	12 
	8882	Presa trasmissione dati categoria 5 completa di viti	Ø 78 mm H 13 mm	12 
	8887	Coperchio di chiusura completo di viti	Ø 78 mm H 13 mm	12
	8888	Coperchio con foro centrale completo di viti	Ø 78 mm H 13 mm	12