



SERIE

Eurocotto











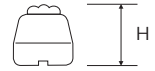
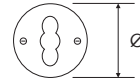

Prese, interruttori, deviatori, pulsanti
in cotto naturale

Riferimenti: Direttiva Bassa Tensione



Isolatore consigliato Cotto



ASPETTO	CODICE	DESCRIZIONE	MISURE	PZ
	7720	Presa polivalente 2P+T 10/16A 250V-	Ø 90 mm H 60 mm	6 
	7721	Interruttore rotativo 10A 250V-	Ø 90 mm H 82 mm	6 
	7722	Deviatore rotativo 10A 250V-	Ø 90 mm H 82 mm	6 
	7723	Pulsante rotativo 10A 250V-	Ø 90 mm H 82 mm	6 
	7724	Pulsante a tasto ottonato 6A 250V-	Ø 90 mm H 68 mm	6 

Prese, scatole di derivazione
in cotto naturale

Riferimenti: Direttiva Bassa Tensione



Isolatore consigliato Cotto

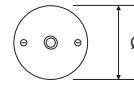

ASPETTO	CODICE	DESCRIZIONE	MISURE	PZ
	7727	Presa universale 10/16A + schuko 250V-	Ø 90 mm H 60 mm	6
	7725	Presa TV Ø 9,5 mm	Ø 90 mm H 60 mm	6
	7726	Presa telefonica con plug 6/4	Ø 90 mm H 60 mm	6
	7728	Scatola di derivazione	Ø 90 mm H 60 mm	6
	7728/GR	Scatola di derivazione grande	Ø 115 mm H 68 mm	4

Prese, rosoni
in cotto naturale

Riferimenti: Direttiva Bassa Tensione



Isolatore consigliato Cotto

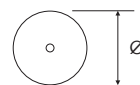

ASPETTO	CODICE	DESCRIZIONE	MISURE	PZ
	7729	Preso trasmissione dati categoria 5	Ø 90 mm H 60 mm	6
	7524	Rosone bombato liscio completo di viti	Ø 90 mm H 50 mm	3
	7531	Rosone bombato lavorato completo di viti	Ø 90 mm H 52 mm	3
	7116	Rosone liscio completo di viti	Ø 90 mm H 42 mm	2
	7117	Rosone lavorato completo di viti	Ø 90 mm H 42 mm	2